

# Product Data Sheet



## RHX0Q2L

Replace "X" with 2, 3, 4, 5 or 6 for number of poles

### Reinforced Class H/K Fuse Panel 60 Amps, 250 Volts AC

#### Wire Range:

Line Side : #2/0 - #14 AWG Copper, Aluminum  
Load Side : #10 - #22 AWG Copper

[See table below for wire sizes.](#)

**Holds fuse sizes: 13/16" diameter X 3"**

Commonly used fuses in this holder: A2Y, CRN, NLN, NON, NRN, OT, OTN, RLN, RF

#### Electrical Ratings:

- 31 - 60A max (amperage rating based on maximum fuse rating for that physical size)
- 250 Volts AC
- Approved for 10,000 Amp Withstand Rating

#### Mechanical Ratings:

- Maximum insulator base temperature: 150 °C (302 °F) UL RT1
- Storage and transportation temperature range: -35 °C to 125 °C (-31 °F to 257 °F)
- Flammability rating of insulator base: UL 94 V-0

#### Materials:

- Fuse Clips: Copper alloy, tin plated
- Bus Bar: High conductivity aluminum, tin plated
- Insulator base: phenolic
- Terminal set screws (Bus Bar): Aluminum, tin plated
- Connector mounting screws: Steel, zinc plated
- Bus Bar mounting screws: Steel, nickel plated



**Agency Approvals:**

- UL Recognized, UL 512 Terminal Block Standard, File No. IZLT2.E35113
- CSA Certified File No. LR21455
- CE compliant to IEC 60947-1
- RoHS Compliant

**Wire Approvals:**

Line Side:

Wire Size	Torque	Copper Wire Stranding Classes - Number of Strands		
		Solid	Class B	Class C
2/0 AWG	120 in. lbs		19	37
1/0	120 in. lbs		19	37
1	120 in. lbs		19	37
2	120 in. lbs		7	19
4	120 in. lbs		7	19
6	120 in. lbs		7	19
8	40 in. lbs		7	19
10	35 in. lbs	1	7	19
12	35 in. lbs	1	7	19
14	35 in. lbs	1	7	19

Aluminum Stranded Wire Range: #2/0 - #14 AWG

Load Side:

Wire Size	Torque	Copper Wire Stranding Classes - Number of Strands		
		Solid	Class B	Class C
10	25 in. lbs	1	7	19
12	25 in. lbs	1	7	19
14	25 in. lbs	1	7	19
16	25 in. lbs	1	7	19
18	25 in. lbs	1	7	19
20	25 in. lbs			
22	25 in. lbs		7	19

- Wire strip lengths: line side (bus bar) - 11/16"
- Hex key needed: 3/16"
- Panel mountable: #10 fastener, torque to 25-30 in. lbs.

**Accessories:**

Printing available: Consult factory

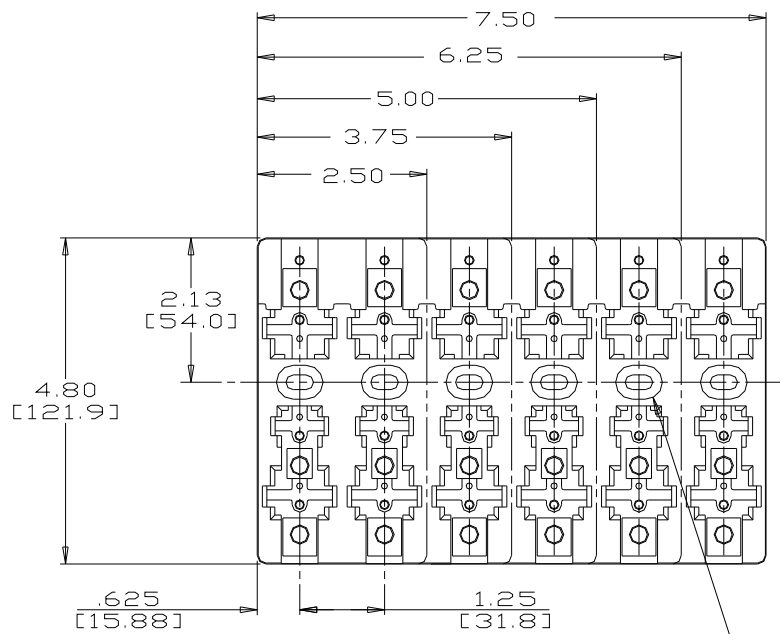

.22[5.6] X .41[10.4] HOLE  
 .50[12.7] X .68[17.3] C'BORE  
 X .55[14.0] DEEP

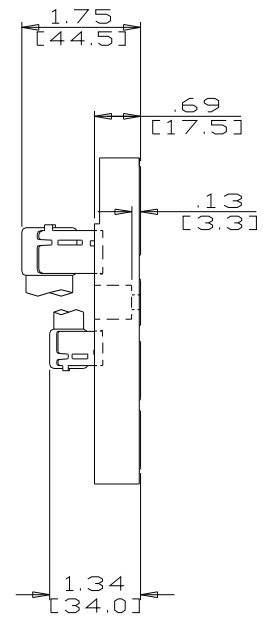

[WWW.MARATHONSP.COM](http://WWW.MARATHONSP.COM)  
 1-419-352-8441

PDS 0188 REV A 10/25/07